









Legende:

-  Hauptzufahrt
-  Hauptzugang
-  Gebäudezugang
-  Überflurhydrant
-  Brandmeldezentrale
-  Feuerwehrschlüsseldepot
-  FW-Informationszentrale
-  Freischaltelement

Feuerwehreinsatzplan

Objekt: **KSI Augsburg**  
 Firnhaberstraße 74 h  
 86159 Augsburg

Übersichtsplan

Datum: 2016-07  
 Erstellung: Quadra Ingenieure  
 Zeltnerstr. 7  
 90443 Nürnberg

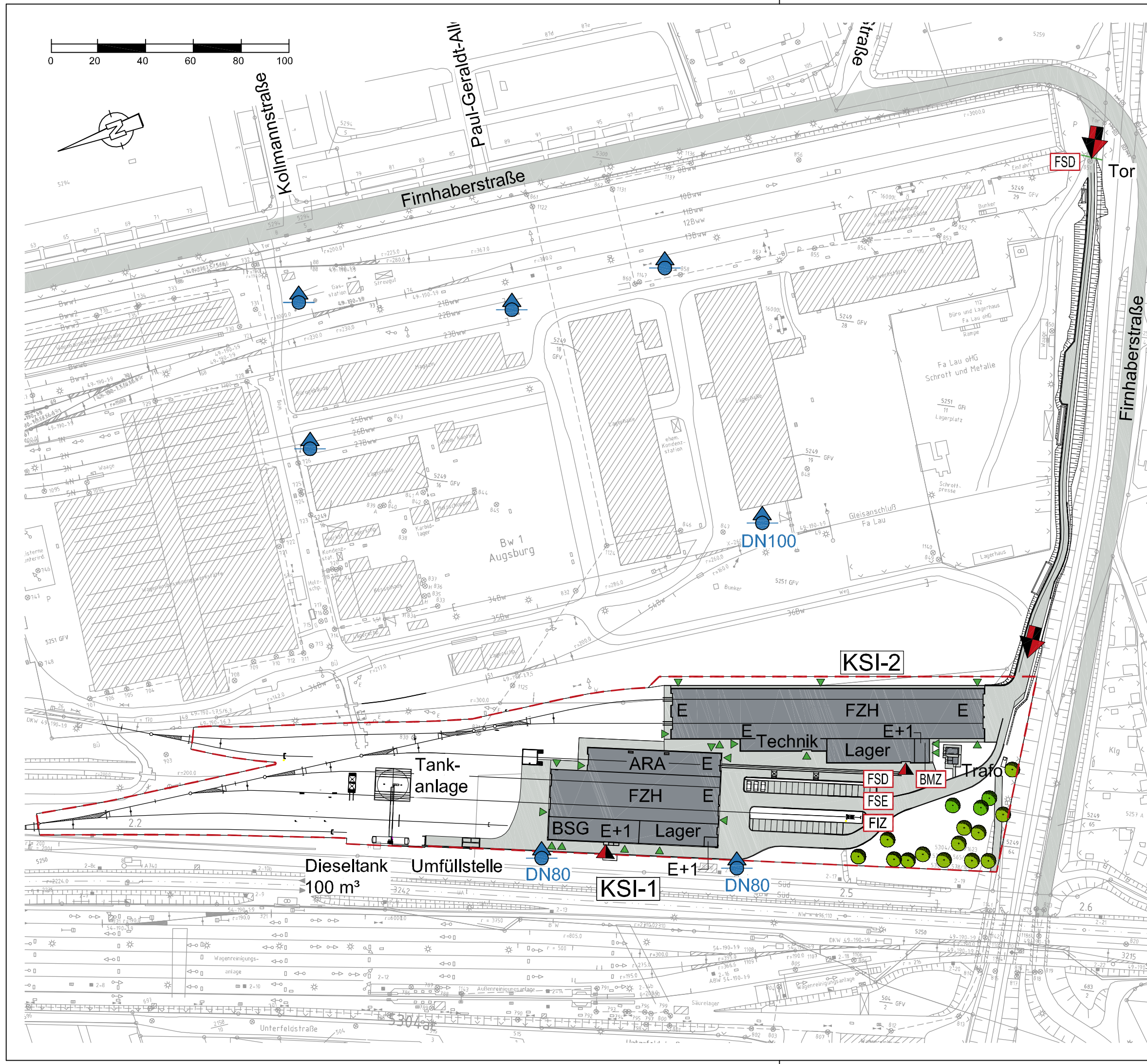

R:\140803\_Anbau KSI Augsburg\4\_plan45\_aust40 FeuerwehplanDWG\Fireweh- und Geschossepläne.dwg, FWP Übersichtsplan, 15.07.2016 16:07:10, s.schinhammer